

WARNING



To reduce the risk of electric shock, do not open or remove the product's casing. There are no user serviceable parts inside. Contact qualified service personnel or authorized service center.

POWER

Only use the provided power adapter to power the monitor.

SAFETY

- ▶ Keep the monitor and power adapter away from water and humidity in order to prevent risk of fire and electrocution.
- ▶ Do not introduce material (solid or liquid) inside the monitor's casing. If this should accidentally occur, disconnect the device from the power outlet and have it inspected by qualified service personnel or authorized service center.
- ▶ Never open the monitor's casing. Always contact qualified service personnel or authorized service center for repairs.
- ▶ Keep the device away from children in order to prevent accidental damages.
- ▶ Do not touch the device with wet hands in order to prevent electrical shock or mechanical damage.
- ▶ Do not use the device if the casing is damaged. There is risk of electrocution. Contact qualified service personnel or authorized service center.
- ▶ It is advisable to disconnect the power adapter if the monitor is not to be used for an extended period of time.

INSTALLATION / USAGE

- ▶ To prevent overheating the monitor, arrange it in a position allowing the flow of air through the slots in the casing. Slots and openings in the casing are for ventilation. These openings must not be blocked or covered. Ensure at least 5 cm of free space. For the same reason, do not install near heat sources, such as radiators or hot air ducts. Keep away from direct sunlight.
- ▶ Do not use in areas subject to excessive dust, mechanical vibrations or shocks.
- ▶ Do not set the monitor on an unstable surface, such as a tottering or slanted table. The monitor could fall causing damages and/or malfunctions.
- ▶ Do not use the monitor in a place where it could be exposed to humidity or water: risk of fire, electrocution or malfunctions.
- ▶ Stop using the monitor if water or other materials should penetrate the interior: risk of fire and electrocution. Contact qualified service personnel or authorized service center.
- ▶ Do not place heavy or heat generating objects on top of the monitor: this could damage the casing and/or increase internal temperature, causing malfunctions.
- ▶ Do not cover the monitor with a cloth or other materials, while it is running, in

order to prevent deforming the external casing and overheating the internal components: risk of fire, electrocution and malfunctions.

- ▶ Keep magnets and magnetic objects away from the monitor in order to prevent malfunctions.
- ▶ Do not use the monitor in the presence of smoke, vapor, humidity, dust or intense vibrations.
- ▶ Wait for a while before operating te monitor immediately after transporting it from a cold place to a warm place and vice versa. Wait on average for three hours: this will allow the monitor to adapt to the new ambient conditions (ex: temperature and/or humidity).
- ▶ The monitor is provided with a base. It can be positioned on a horizontal surface, such as a desk or a table. Make sure that the base is fastened firmly to the monitor and that it is not set on an unstable surface. A drop could cause damages or malfunctions.
- ▶ Adjust the brightness and contrast to obtain a perfect image.
- ▶ The monitor can also be installed on the wall by means of a VESA mount (not provided).

CLEANING

- ▶ Before cleaning, turn off the monitor and unplug the power adapter from the power outlet.
- ▶ Wipe delicately with a dry cloth to remove dust and dirt.
- ▶ If the dirt cannot be removed with a dry cloth alone, apply a small amount of neutral detergent in a cloth. Squeeze the cloth to remove the excess detergent before cleaning the monitor. Wipe delicately.
- ▶ Do not use volatile liquids (such as petrol, alcohol, solvents, etc.) or chemically treated cloths, preventing deformation, deterioration or scratches to the monitor's casing or screen.

CONNECTIONS



Power in

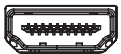

HDMI 2.0 (2)

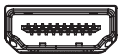

HDMI 2.0 (1)



Display Port 1.4





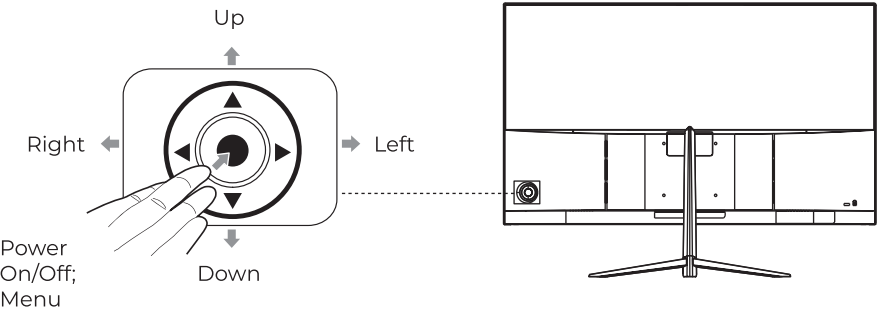

3.5mm audio out

BUTTON FUNCTIONS



SHORTCUT FUNCTIONS

When the monitor is powered on, you can use the buttons as described below.

BUTTON	FUNCTION
 Power / Menu	Press and hold for 1 second to power on. Press and hold for 3 seconds to power off.
 Left / Right	Left - Input adjustment. Right - Brightness adjustment.
 Up	Eco function.
 Down	Contrast adjustment.

SETTINGS

All the monitor's settings can be adjusted through the OSD (On Screen Display) menu.

- 1) Press the Menu button to access the monitor's settings;
- 2) Press the Right / Left and the Up / Down buttons to navigate through the different settings and adjust the respective values;
- 3) Press the Menu button to confirm the adjustment;
- 4) Press the Left button to return to the previous menu.

LCD MONITOR PIXEL POLICY

LCD screens are made up of small elements called pixels. Each pixel is made up of sub-pixels in red, green and blue colors. If, by any chance, one of these sub-pixels has a problem, this can result in a specific point that remains either continuously illuminated (bright) or off (dark). This is a common situation, regardless of brand or manufacturer, in which one or more of these sub-pixels can become stuck in an invariable state. The occurrence of defective sub-pixels appears as follow:

- ▶ White Color: Indicates a sub-pixel that remains continuously illuminated (always on).
- ▶ Black Color: Refers to a sub-pixel that remains continuously dark (always off).
- ▶ Red, Green or Blue Colors: They signal a stuck sub-pixel, that is, it can be always on or always off.

The specifications for the number of defects considered acceptable are:

Panel Type	Full HD
Native Resolution	1920x1080px
Bright Sub-pixel	3
Dark Sub-pixel	3
Total allowable sub-pixel	5



FOLD

FOLD

TECHNICAL ASSISTANCE

Regarding technical issues, please visit www.ilectry.eu or contact us through support@ilectry.eu.

CE STATEMENT OF COMPLIANCE WITH EUROPEAN UNION DIRECTIVES

ilectry declares that this product is in compliance with the essential requirements and other relevant provisions from the following Directives: 2014/30/EU; 2011/65/EU; 2014/35/EU; 2017/1369/EU; 2009/125/EU, as applicable.
The technical documentation required by the Conformity Evaluation Process is in ilectry's possession and can be requested through support@ilectry.eu.

DISPOSAL OF BATTERIES AND ELECTRICAL OR ELECTRONIC EQUIPMENT WASTE

The existence of this symbol on the product, batteries or respective packaging, signifies that this product and the contained batteries can not be disposed as domestic waste. It is the user's responsibility to deliver this product at a batteries, electrical or electronic recycling pick-up point. The pick-up and separate recycling contributes for the preservation of natural resources and supresses potential negative consequences for the human health and the environment resultant of inadequate disposal of dangerous substances contained in batteries and electrical or electronic equipment. For additional informations regarding batteries, electrical or electronic recycling pick-up points, please contact your local municipal services.



FOLD

FOLD



ilectry IYVISION24524

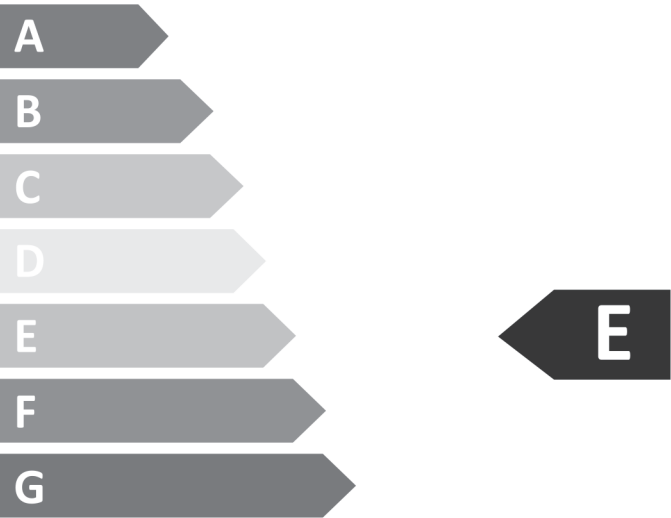

18 kWh/1000h

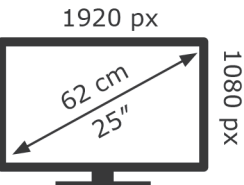

2019/2013

FOLD

FOLD

ilectry



25" LED Gaming Monitor
FHD · VA · 240Hz · 1ms

User Guide